

REVISIONS		DATE
IR	INITIAL RELEASE	6/15/2009
A	EDITED TITLE BLOCK	10/7/2014
B	EDITED NOTES	10/8/2014
C	EDITED NOTES	8/26/2015

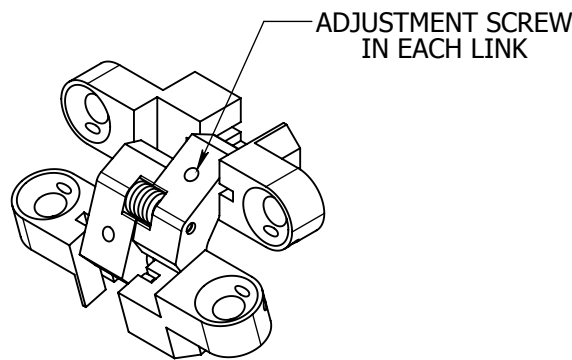

PN: SH105-A-OPEN

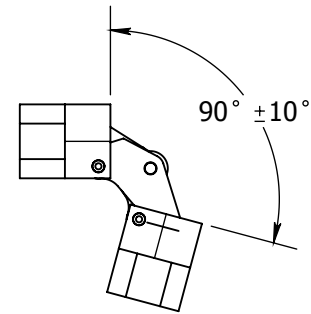
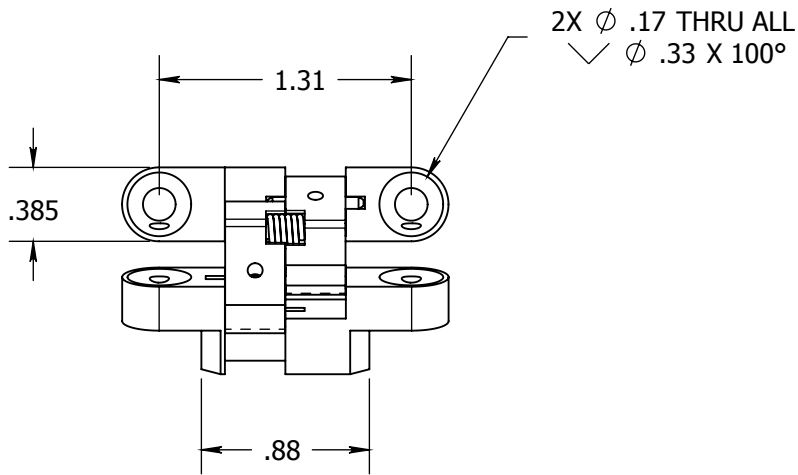
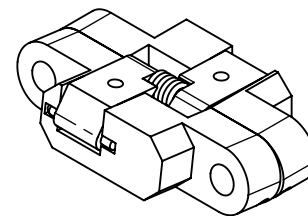

PN: SH105-A-CLOSE

NOTES:

1. USE THE -OPEN MODEL WHERE FORCE WANTED IN THE OPEN DIRECTION
2. USE THE -CLOSE MODEL FOR SELF CLOSING HINGE.
3. INSTALL USING NAS514P832 SCREW (4X) OR EQUIV.
4. STANDARD FINISH: BLACK ANODIZE
5. OPTIONAL FINISH: CLEAR ANODIZE
6. USE 0.035" HEX DRIVER TO REDUCE OPEN ANGLE
7. MINIMUM PANEL THICKNESS 0.50"

<p>PROPRIETARY AND CONFIDENTIAL</p> <p>THE INFORMATION CONTAINED IN THIS DRAWING IS THE SOLE PROPERTY OF SAINT LOUIS DESIGNS. ANY REPRODUCTION IN PART OR AS A WHOLE WITHOUT THE WRITTEN PERMISSION OF SAINT LOUIS DESIGNS IS PROHIBITED.</p>			<p>UNLESS SPECIFIED OTHERWISE DIMENSIONS ARE IN INCHES</p> <p>TOLERANCES:</p> <p>ANGULAR: ±1°</p> <p>TWO PLACE DECIMAL ±0.01</p> <p>THREE PLACE DECIMAL ±0.005</p> <p>SURFACE FINISH: 32 RMA</p> <p>MATERIAL 7075-T651</p> <p>QQ-A-225/9</p> <p>FINISH</p> <p>SEE NOTES</p> <p>DO NOT SCALE DRAWING</p>		NAME	DATE	<p>Saint Louis Designs, Inc.</p> <p>PO BOX 3400, Austin, TX78764</p> <p>512-472-4711, www.saintlouisdesigns.com</p> <p>SPRING LOADED HINGE</p> <table><tr><td>SIZE</td><td>DWG. NO.</td><td>REV.</td></tr><tr><td>A</td><td>SH105-A</td><td>C</td></tr><tr><td colspan="2">SCALE:1:1</td><td>SHEET 1 OF 1</td></tr></table>	SIZE	DWG. NO.	REV.	A	SH105-A	C	SCALE:1:1		SHEET 1 OF 1
	SIZE	DWG. NO.		REV.												
	A	SH105-A		C												
	SCALE:1:1			SHEET 1 OF 1												
				DRAWN	MSTL	6/15/2009										
				CHECKED												
				ENG APPR.												
				MFG APPR.	MSTL	6/15/2009										
				Q.A.												
				COMMENTS:												
	DEBUR AND BREAK SHARP EDGES															